



K981 Series

40A Power PCB Relay



P.O. Box 1464, Crystal Lake, IL 60014 (815) 455-0846

Visit our website at www.kgtechnologies.net
E-mail inquiries to info@kgtechnologies.net

Features

- DPST-NO 40Amp compact package (40 X 27 X 35)mm
- PCB mounting



K981 Specifications

Contact Data		Characteristics	
Rated load (Resistive)	40A	Insulation resistance	100M ohm
Rated load (Inductive)		Dielectric strength:	
Contact arrangement	DPST-NO	coil to contact	1500 Vac
Contact material	Silver Cadmium	across open contacts	1500 Vac
Initial contact resistance	<100m Ohm	Operate time	< 25ms
Max. operating current	40A	Release time	< 25ms
Max. operating voltage	250Vac	Operating temperature	-40C to + 60C
Expected life:		Dimensions	(40 X 27 X 35)mm
electrical (full load)	100,000		
mechanical	1,000,000		

Coil data	
Coil consumption	DC 1.8W
Pull-in voltage	80% of nominal
Dropout voltage	10% of nominal
Insulation system	> 500M ohm

Nominal input voltage	Nominal resistance	Nominal power
	Ohms	(Watts)
5Vdc	16.7	1.5
12Vdc	96	1.5
24Vdc	384	1.5
48Vdc	1536	1.5

Safety approvals					
UL	cUL	CSA	TUV	VDE	
*X	*X			*X	*Pending

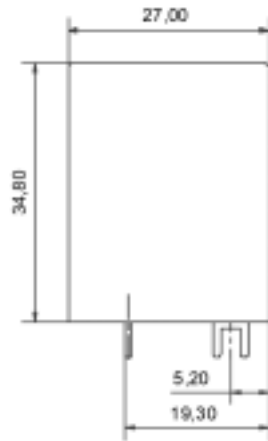
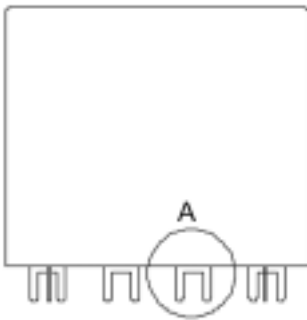
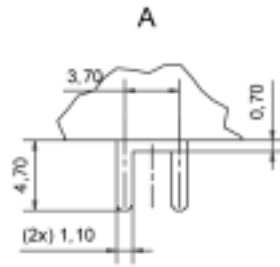
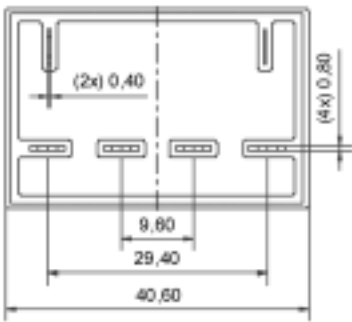

K981

Ordering Information

K981 P BXX S 012D 00

Series

Terminals
P = Printed Circuit

Contact Configuration
BXX = 2 form A (DPST -NO)

Features
S = Sealed

Special Features
00 = Standard

Coil Voltage

- 005D = 5 VDC
- 006D = 6 VDC
- 012D = 12 VDC
- 024D = 24 VDC
- 048D = 48 VDC
- 110D = 110 VDC
- 006A = 6 VAC
- 012A = 12 VAC
- 024A = 24 VAC
- 048A = 48 VAC
- 120A = 120 VAC
- 220A = 220 VAC